



The Avenue

Revitalization of Pennsylvania Avenue



Fall 2011

This newsletter is designed to keep you informed about the reconstruction of Pennsylvania Avenue and upcoming construction activities that affect your community.

In This Issue

LIDs & Catch Basins	1
Phases	2
Feedback	2
Progress Pictures	3
Project Timeline	4
Contact Information	4

Great Streets | Great Improvements

Low-Impact Development (LID) & Catch Basins



Low-Impact Development (LID) at the intersection of Pennsylvania Avenue at 31st Street.

Low-Impact Development (LID), including bioretention facilities and permeable paving, collects rainwater and removes sediment and pollutants from the water before it is released downstream. In other words, they improve and protect the quality of the rivers and streams that are in your community!

Each bioretention facility, often called a rain garden, consists of a stone buffer area, water collection area, mulch, soil and plants that perform a specific function in the filtration process and help to remove the pollutants from the rainwater runoff. These plant-based rain gardens can be found along Pennsylvania Avenue SE at the intersections of 29th Street SE, 31st Street SE and Alabama Avenue SE, where they collect the rainwater that would normally drain off the roadways and directly into the storm sewers.

In addition to the LIDs that can be

found along the corridor, many water quality catch basins have been installed throughout the project. Catch basins prevent large objects, debris and sediment from flowing into the sewer system, and are designed to drain excess rain and ground water from streets and sidewalks. Additionally, catch basins filter rainwater through four chambers before releasing the water into the drainage system. The large scale of these water inlets ensures that during heavy rain storms, the water is carried off the streets and does not flood the roadway.

Check out the LIDs and catch basins the next time you ride through the Pennsylvania Avenue corridor!

Benefits...

- Improves quality of water
- Removes pollutants
- Reduced quantity of water runoff & flood control
- Increased aesthetics



DDOT and its contractors are working diligently to complete this project as quickly as possible and with safety in mind! As you travel through the project, please continue to obey all traffic laws, including posted speed limits, and drive carefully through this work zone.



District Department of Transportation



Construction | Phases

The Pennsylvania Avenue Great Streets Project was contracted to be completed in four major phases between December 2009 and December 2011. After construction began, District Department of Transportation (DDOT) determined a sense of urgency to complete the portion of the project between 27th Street SE and Branch Avenue SE to lessen the impact on the residents, business owners and the traveling public. With a completion goal of October 31, 2010, the construction team began to accelerate construction.

Working 7 days a week, the contractor was able to achieve this accelerated schedule and completed a substantial amount of major road work between 27th Street SE and Branch Avenue SE by the anticipated date. Traffic in this area now flows with two lanes in each direction and designated left-turn signals at most intersections.

Construction between Branch Avenue SE and Southern Avenue SE is proceeding on the original schedule. Phase 2, the right westbound lane, is to be completed Fall 2011. Phase 3, the middle eastbound lane, is scheduled to begin in Fall 2011 and completed in December 2011. Phase 4, the middle westbound lane, is scheduled to begin late Fall 2011 and be completed in December 2011.

All major construction on the Pennsylvania Avenue Great Streets Project is scheduled to be completed by December 2011; however, all final landscaping and “punch list” items will wrap up early spring 2012.

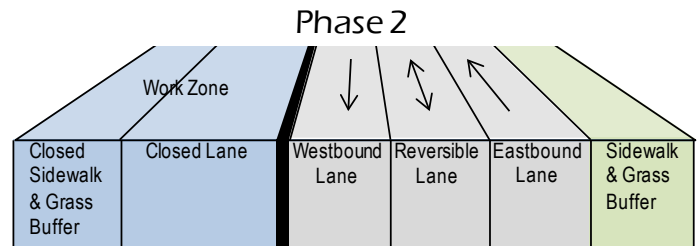

Closed right westbound lane and sidewalk

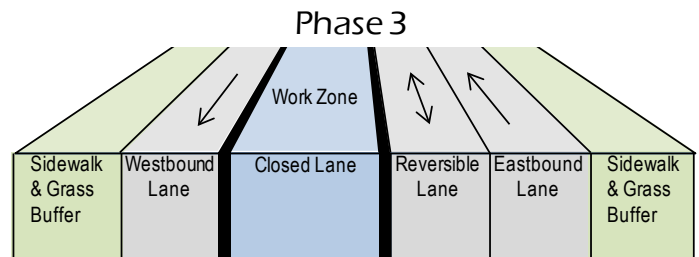

Closed middle westbound lane for construction of the roadway and portions of raised median

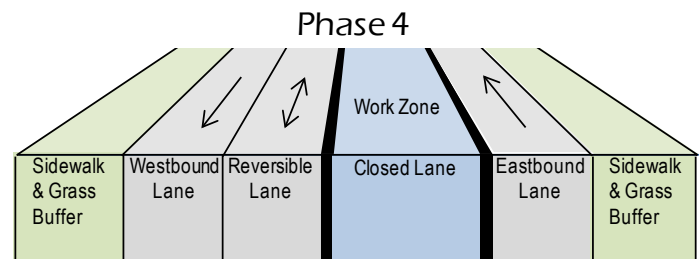

Closed middle eastbound lane for construction of the roadway and portions of raised median

- Work Zone
- Active Lanes
- Pedestrian Area
- Barrier

Community | Resident Feedback

Ms. Young,

I am truly impressed with the changes I am seeing on Pennsylvania Avenue, and I think it is wonderful, probably long-overdue, but wonderful nevertheless. I live on 30th Street SE going towards Randle Highlands, and trust me, if our street needs revitalization, I would say go for it! I fully embrace change; doing the same things gets you the same results, doing something different, gets you different results.

Keep up the good work!

- Ward 7 Resident

FAQ | You ought to know...

- Q:** Will any parking be restored on Pennsylvania Avenue when the construction project is completed?
- A:** Yes! Parking on Pennsylvania Avenue SE will be restored in designated areas between Fort Davis Street SE and Southern Avenue SE. Look for limited parking on the north side and south side of Pennsylvania Avenue SE with rush-hour restrictions in this area.

Contact Chinaka A. Young at 202.641.6739 or chinaka.young@volkert.com with any additional questions or feel free to stop by our field office at 2410 Minnesota Avenue SE.

Photo Finish | Progress on Penn!

Many exciting changes have already taken place since the beginning of the construction project. As we proceed with work, you will continue to see new things that were designed to improve the look and feel of Pennsylvania Avenue SE. These changes are also very beneficial to the community. Take a look at the great progress that has been made so far!



Southeast White House

From the beginning of this project, the Pennsylvania Avenue Great Streets project team has worked closely with Sammie Morrison and Scott Dimock, cofounders of the Southeast White House, to ensure that our reconstruction of the community's "little white house" is aligned with the vision they had in mind for this neighborhood staple.

Retaining Walls

Simply put, a retaining wall is constructed to resist the pressure of soil. Along Pennsylvania Avenue SE, six granite walls in total will be rebuilt and/or constructed by the end of the project using a technique called "sheet piling". This picture shows one of the new granite walls that currently line the corridor.



Landscaped Medians

The landscaped medians were designed to improve the character of the neighborhood, create a safe-haven for pedestrians as they cross the street and to promote vehicular safety along the heavily-traveled corridor. The medians along the corridor will be home to lots of plant life including Bald Cypress, Sumac trees, Lily Turf and Carpet Rose.

Driveway Aprons

While the landscaped medians were designed with a specific purpose in mind, medians make it more difficult to turn into a driveway. With that in mind, the project was designed to include widened driveway aprons that allow for easier access into a property.



Send your email address to chinaka.young@volkert.com to be added to our mailing list!

District Department of Transportation
 c/o David Volkert & Associates Engineering, P.C.
 2410 Minnesota Avenue SE
 Washington DC 20020

Project Timeline

Construction on the Pennsylvania Avenue project is contingent upon weather conditions and consequently may increase or decrease the anticipated timeline.



Construction Phase	Time Period	Construction Activities
Phase 1	Fall 2010 - Spring 2011	Reconstruction of right eastbound lane - COMPLETE
Phase 2	Spring 2011 - Fall 2011	Reconstruction of right westbound lane from Branch Avenue SE to Southern Avenue SE (27 th Street to Branch Avenue SE completed)
Phase 3	Fall 2011 - December 2011	Reconstruction of inside eastbound lane from Branch Avenue SE to Southern Avenue SE (27 th Street SE to Branch Avenue completed)
Phase 4	December 2011	Reconstruction of inside westbound lane from Branch Avenue SE to Southern Avenue SE (27 th Street to Branch Avenue completed)

Note: Major work is scheduled to be completed by December 2011; however, all final landscaping and “punch list” items will wrap up early spring 2012.

Project Contacts

d.
 District Department of
 Transportation
www.ddot.dc.gov
 Luan Tran
 202.671.4649

www.ddot.dc.gov/pennave
 Chinaka A. Young
 202.641.6739

 District Department of
 Transportation

www.twitter.com/DDOTDC