



The Avenue

Revitalization of Pennsylvania Avenue



January 2010

This newsletter is designed to keep you informed about the reconstruction of Pennsylvania Avenue and upcoming construction activities that affect your community.

In This Issue

Project Overview	1
Project Map	2
Team Introduction	2
Phases & Impacts	3
Project Timeline	4
Contact Information	4

Great Streets | Great Improvements

America's Main Street Gets a Makeover

The transformation of Pennsylvania Avenue, SE is underway as the District Department of Transportation (DDOT) and the Federal Highway Administration (FHWA) kickoff the new year with another American Recovery and Reinvestment Act of 2009 (ARRA) construction project. The \$30 million Pennsylvania Avenue Great Streets project extends two miles east of the Sousa Bridge, beginning 200 ft. west of 27th Street, SE and ending at Southern Avenue, SE. The construction is scheduled to be completed in several phases over the next two-and-a-half years.

DDOT worked closely with other city agencies, regional partners, and local

community groups throughout the planning and development of this project. The local groups provided valuable insight into the traffic safety concerns and problems impacting this major commuter route. Working together, this team produced a project designed to dramatically improve the look and feel of the corridor and strengthen transportation operations and safety for all users.

New sidewalks will be constructed on both sides of the street for the full length of Pennsylvania Avenue boosting the safety of pedestrians as they travel along the roadway. New

continued on page 2



District Department of Transportation



Heading west on Pennsylvania Avenue SE towards the Sousa Bridge.

Project Map | Area of Impact

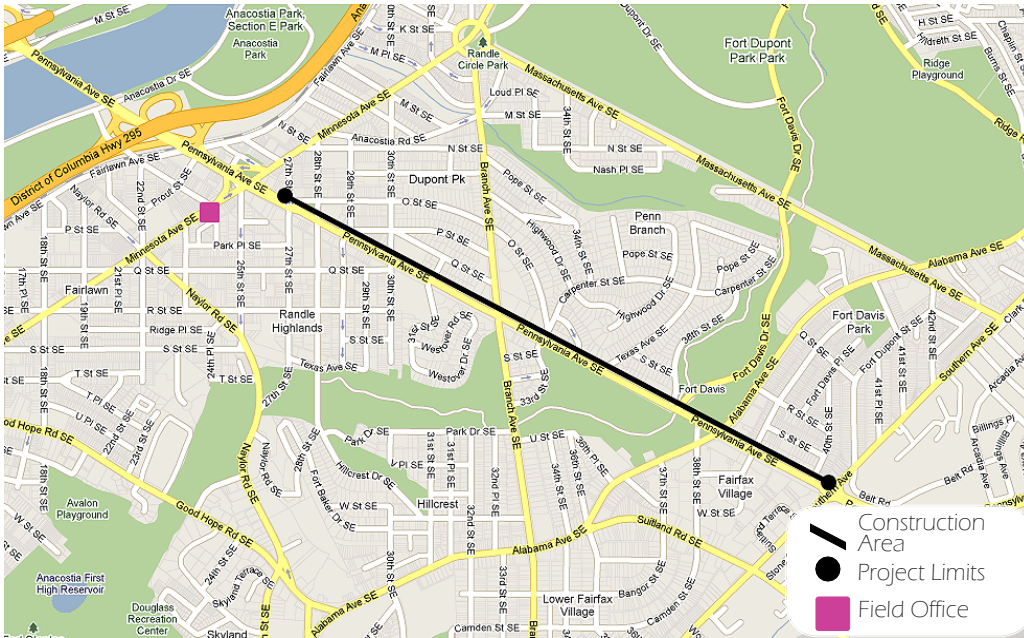

The Great Streets: Pennsylvania Avenue Project will extend two miles east of the Anacostia River on Pennsylvania Avenue beginning 200 ft. west of 27th Street SE to Southern Avenue SE.

continued from page 1

street lighting along the corridor will maximize visibility for motorists and increase safety in the community by decreasing dark spots. Special treatments in the commercial areas will not only create a distinct appearance for Penn-Branch Shopping Center and Fairfax Village Shopping Center areas, but allows all foot traffic a more pedestrian-friendly shopping area. Additional upgrades include a completely landscaped median that will provide walkers a safe place to stand in the middle of an active avenue, new crosswalks, and improved signal and traffic management.



Driving east on the project route.

Be on the lookout for electronic message signs along the corridor announcing the start of construction on this project. For more information about the Pennsylvania Avenue Great Streets Project visit www.ddot.dc.gov/pennave and/or email us at ddotpublicaffairs@dc.gov.

DDOT recognizes that road construction is an inconvenience to the residents and business owners of your community and we thank you for your patience as we revitalize “America’s Main Street.”



Eastern end of the project near Southern Avenue.

Meet The Team | Office Location + Hours



l. to r. Ben Lineberry, Construction Manager; Chinaka A. Young, Public Outreach Coordinator; Danny Lyons, Lead Inspector

The District Department of Transportation’s team on this project includes Fort Myer Construction Corporation as the construction contractor with David Volkert & Associates providing the construction management. Together with DDOT, they form a strong team committed to the community and the success of this initiative. The construction team and key DDOT staff, including Project Manager, Luan Tran, are located at the construction field office.

The team is available to meet with you Monday through Thursday during office walk-in hours or by appointment. Please call or drop by with any questions and/or concerns you may have.

Construction Field Office:

Chinaka A. Young
2410 Minnesota Avenue SE
202.641.6739

Walk-in Hours:

Monday - Thursday
1:00 pm - 4:00 pm



Construction | Impacts

There are four major phases of construction during the two-and-a-half-year construction time frame. Prior to the start of Phase 1, temporary lane closures are scheduled to allow for the installation of storm drains and utilities throughout the corridor. By phasing construction, DDOT is able to maintain three open travel lanes – an in-bound, an out-bound and an AM and PM reversible lane.

The impacts of the construction activities are described below:

- The roadway under construction will be limited to a length of up to 2,000 feet at a time.
- Concrete barriers or barrels will mark off the closed areas of construction.
- The middle lane will function as the AM and PM reversible lane during the phases of the construction.
- Access to, and left-turns onto some side streets will be restricted. Detours will route traffic around these restrictions.
- Some side streets will be closed during reconstruction of intersections and detours will be implemented.
- Sidewalks will be closed at times with signs posted to indicate detours.
- Access to some residential units will be impacted by construction of the new retaining walls, sidewalks and entry steps.
- Several bus stops will be relocated temporarily while new construction occurs.
- There will be no on-street parking during or after construction.
- Electronic Variable Message Signs (VMS) will be located throughout the project to indicate upcoming activities.
- Construction will be completed in four phases with work hours from 7:00 am – 7:00 pm Monday through Saturday. There will be no work on Sundays.

Construction | Phases

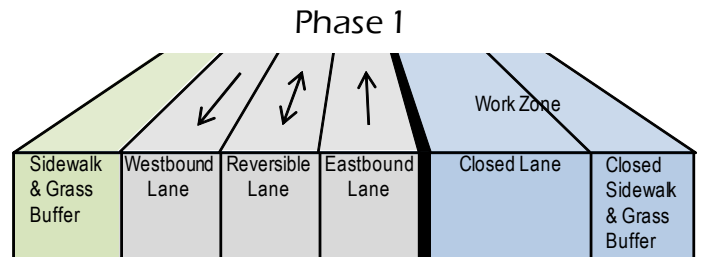

Closed right eastbound lane and sidewalk is scheduled to be in effect on or about May 2010

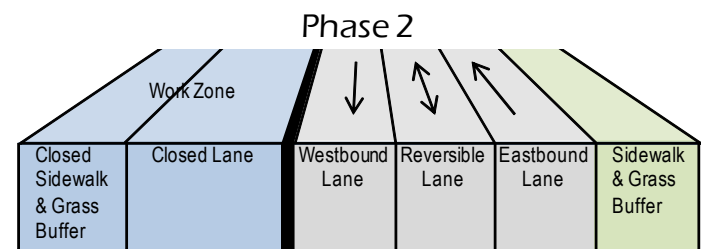

Closed right westbound lane and sidewalk

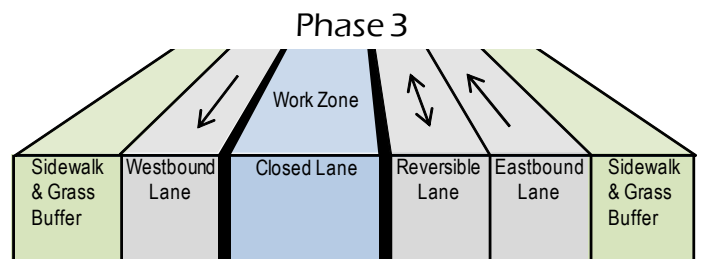

Closed middle westbound lane for construction of the roadway and portions of raised median

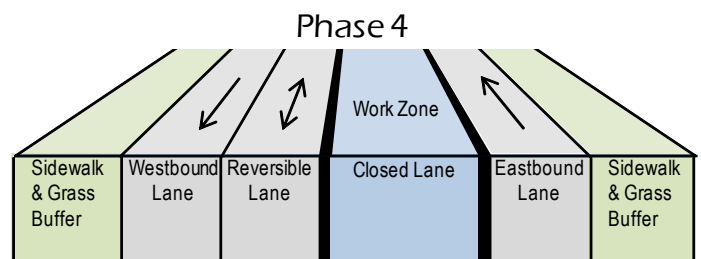

Closed middle eastbound lane for construction of the roadway and portions of raised median



District Department of Transportation
 c/o David Volkert & Associates Engineering, P.C.
 2410 Minnesota Avenue SE
 Washington DC 20020

Project Timeline

Construction on the Pennsylvania Avenue project is contingent upon weather conditions and consequently may increase or decrease the anticipated timeline.



Construction Phase	Time Period	Construction Activities
Phase 1	Winter 2009 - Fall 2010	Reconstruction of right eastbound lane
Phase 2	Winter 2010 - Summer 2011	Reconstruction of right westbound lane
Phase 3	Fall 2011 - Spring 2012	Reconstruction of inside eastbound lane
Phase 4	Spring 2012 - Summer 2012	Reconstruction of inside westbound lane

Project Contacts

d.
 District Department of
 Transportation
www.ddot.dc.gov
 Luan Tran
 202.671.4649

www.ddot.dc.gov/pennave
 Chinaka A. Young
 202.641.6739

 District Department of
 Transportation

www.twitter.com/DDOTDC